

NEW ROOF BEAM

$$S_{MAX} = 33'$$

$$LOADING: \frac{60}{2} \times 50$$

$$1500 \times 1ft$$

$$M = \frac{1500 \times 33^2}{8}$$

$$= 204 \text{ K-ft}$$

USE W 18x60

$$R = 1500 \times 33 =$$

$$49.5 \text{ K}$$

$$FOOTING: \sqrt{\frac{49.5}{1.5}} = 5.75$$

COL. 13' TALL

6x6" HSS

1/4 WALL

CAPACITY 93k o/c

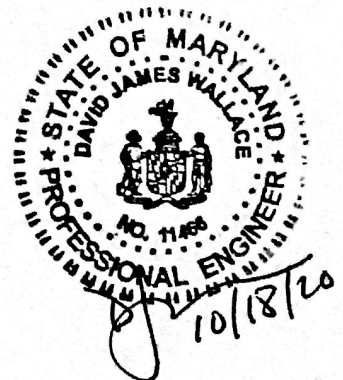

Professional Certification: I hereby certify that these documents were prepared or approved by me. I am a duly licensed professional engineer under the laws of the State of Maryland. License #11466 Exp: May 28, 2021

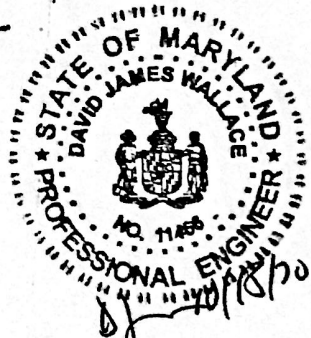
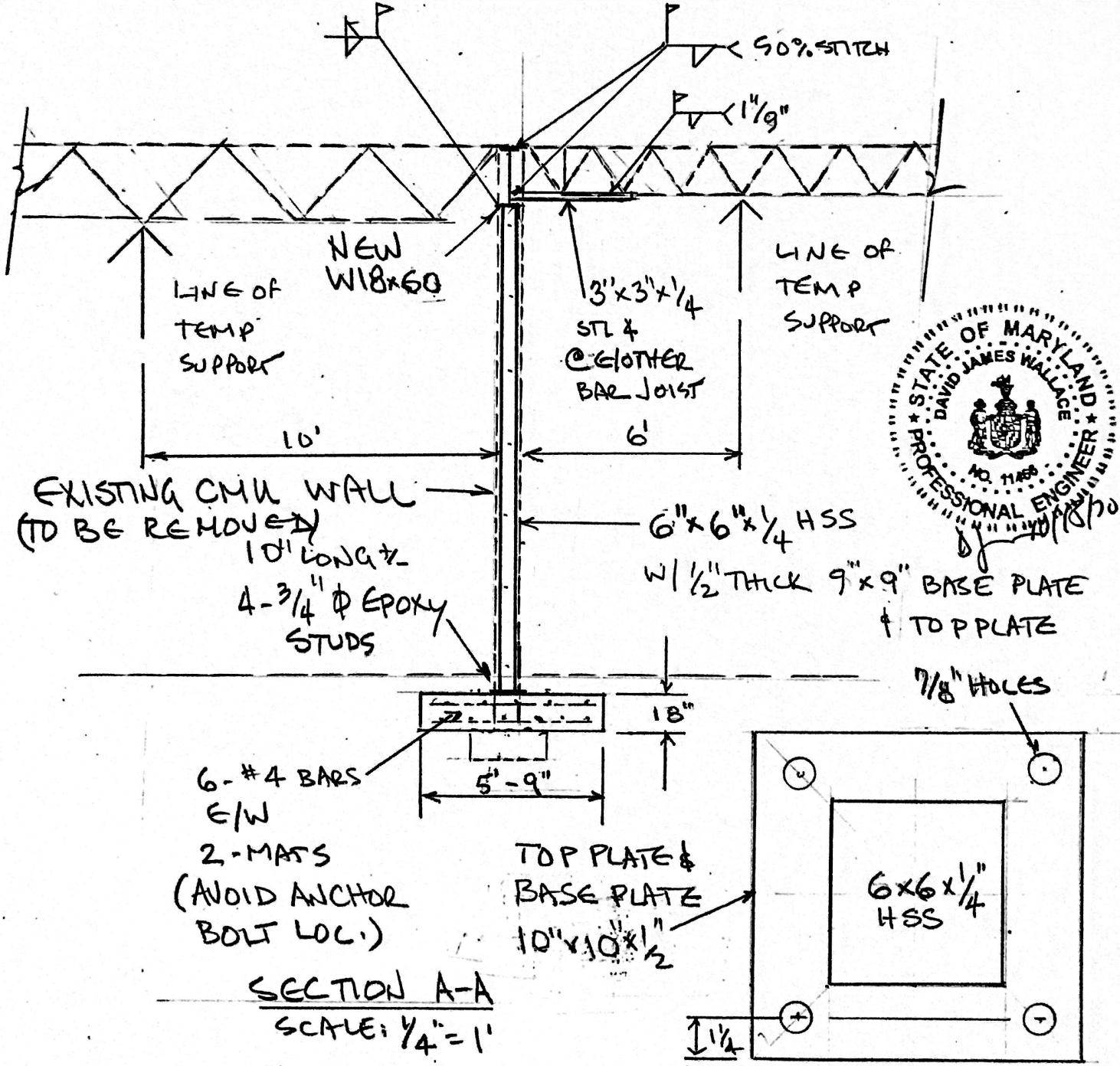
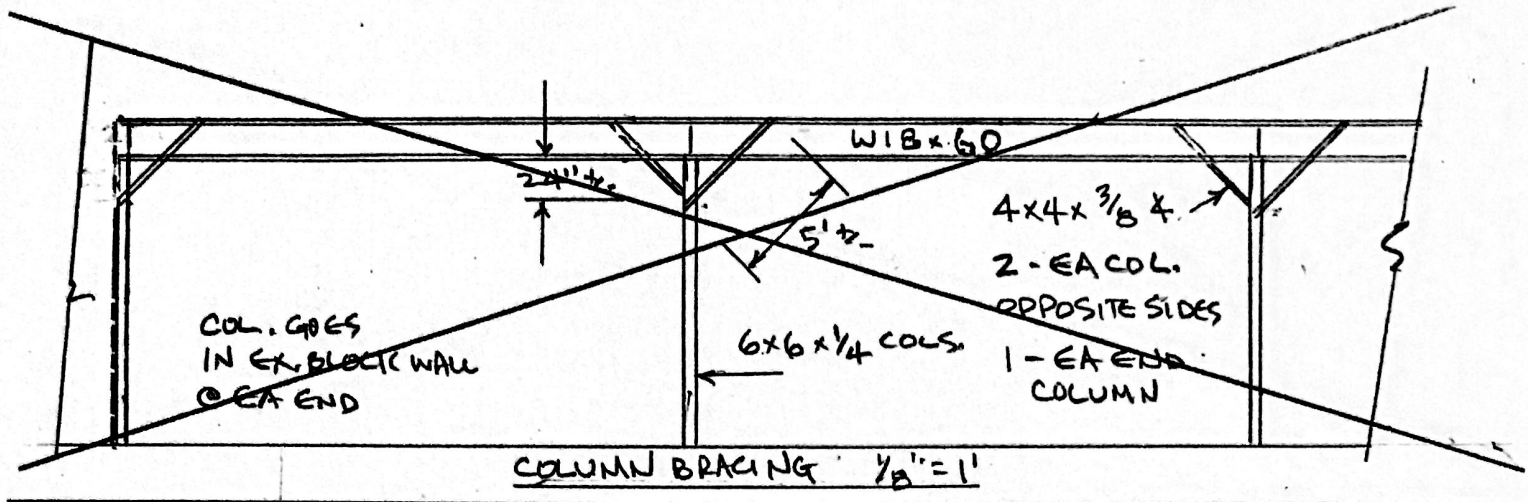

SECTION A-A
SCALE: 1/4" = 1'

